

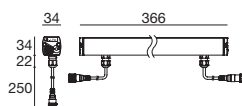

## TCS valve and electric protection

Electrical, mechanical and thermal protections ensure **Xenia 2.0** a long operating life. These lighting fixtures are equipped with a TCS® Valve, specially designed to prevent moisture from forming inside the body, while safeguarding the integrity of electrical circuits and LEDs. The **Xenia 2.0** also comes with electrical (**OVP**) and thermal protections that ensure correct operation and maximum safety. They are protected from overvoltage thanks to the **OVP** (overvoltage protection) device that provides surge protection up to 6kV between Phase and Neutral and up to 10kV between Phase /Neutral and Earth. Thermal protection prevents overheating thus ensuring **Xenia 2.0** reliability and long operating life.

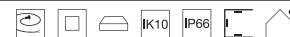

**Xenia 2.0\_X ON/OFF** | Linear profiles | 100-240V | powerLED | 20 W/m

366mm - 6W	type	colour	optic
Anod. Al.	CRI 80	3000 K 703 lm	M. Flood <b>20</b>
3 LEDs		4000 K 749 lm	Flood <b>50</b>
			W. Flood <b>90</b>
			Elliptic <b>25</b>
			Asym. <b>07</b>

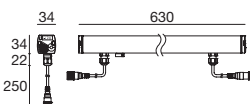

630mm - 12W	type	colour	optic
Anod. Al.	CRI 80	3000 K 1406 lm	M. Flood <b>20</b>
6 LEDs		4000 K 1498 lm	Flood <b>50</b>
			W. Flood <b>90</b>
			Elliptic <b>25</b>
			Asym. <b>07</b>

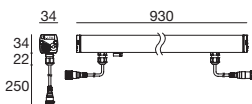

930mm - 18W	type	colour	optic
Anod. Al.	CRI 80	3000 K 2109 lm	M. Flood <b>20</b>
9 LEDs		4000 K 2247 lm	Flood <b>50</b>
			W. Flood <b>90</b>
			Elliptic <b>25</b>
			Asym. <b>07</b>

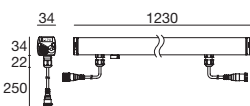

1230mm - 24W	type	colour	optic
Anod. Al.	CRI 80	3000 K 2812 lm	M. Flood <b>20</b>
12 LEDs		4000 K 2996 lm	Flood <b>50</b>
			W. Flood <b>90</b>
			Elliptic <b>25</b>
			Asym. <b>07</b>

**Cables****Power cable - 190~250V AC - 24V DC**

1,5 m F 4 pin M12	4 x 0,5 mm²	<b>99216</b>
5 m F 4 pin M12	4 x 0,5 mm²	<b>89190</b>

**Extension power cable - 190~250V AC - 24V DC**

1 m M + F 4 pin M12	4 x 0,5 mm²	<b>98437</b>
5 m M + F 4 pin M12	4 x 0,5 mm²	<b>98149</b>
10 m M + F 4 pin M12	4 x 0,5 mm²	<b>89188</b>

**CUSTOM**On request the light profile is available with **DALI** or **1/10V** power supplyOn request the light profile is available with **Narrow Spot** (8°)**Accessories****Anti-Glare**

For Xenia 2.0 366mm	<b>98782</b>
For Xenia 2.0 630mm	<b>98783</b>
For Xenia 2.0 930mm	<b>98784</b>
For Xenia 2.0 1230mm	<b>98785</b>
More information	82

**Adjustable brackets**

Lenght from 46mm to 67mm	<b>98949</b>
More information	84

**Fixed steel brackets**

Lenght 90mm	<b>89045</b>
Lenght 150mm	<b>89046</b>
Lenght 300mm	<b>89047</b>
More information	84





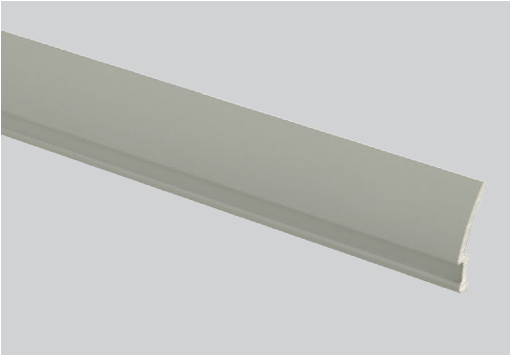

type	suitable for	
Anod. Al.	Xenia 2.0 366 mm	98782
Anod. Al.	Xenia 2.0 500 mm	98951
Anod. Al.	Xenia 2.0 535 mm	98953
Anod. Al.	Xenia 2.0 630 mm	98783
Anod. Al.	Xenia 2.0 930 mm	98784
Anod. Al.	Xenia 2.0 1182 mm	98952
Anod. Al.	Xenia 2.0 1230 mm	98785

Anti-glare

The **anti-glare** accessory greatly reduces the front glare of the LEDs. It is ideal in combination with the Asymmetric and Flood optics in wall lighting fixtures. This accessory can be easily installed by the customer even after the assembly of the LED lighting fixture (see Figures 1 and 2).

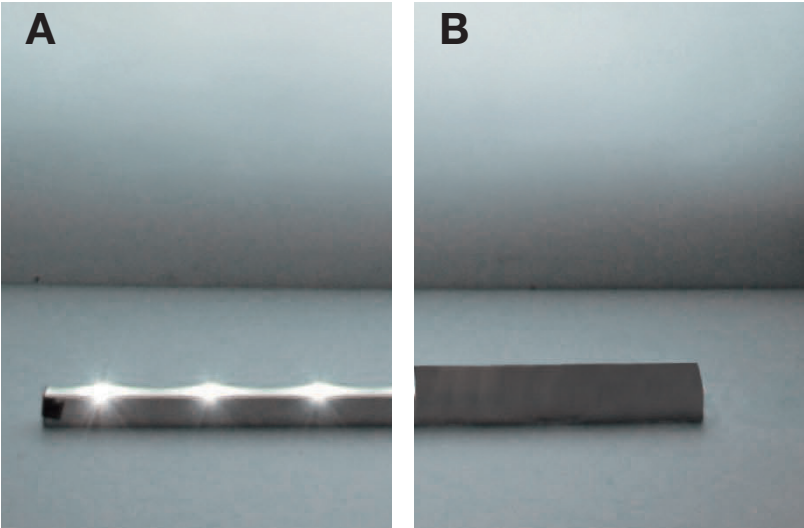
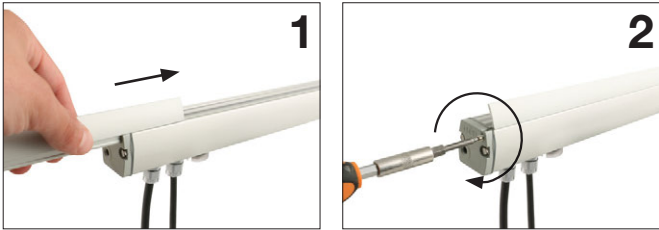

View of the bar with (fig. B) and without (fig. A) the anti-glare accessory.  
Note that the light emission is not reduced by eliminating the front glare of the LEDs.

### Adjustable fixing bracket

Stainless steel brackets can be adjusted with a high level of precision both in rotation and in height (46mm to 67mm) for an accurate orientation of the light beam.

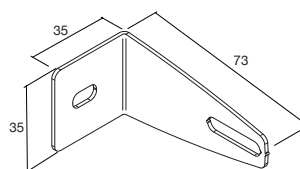
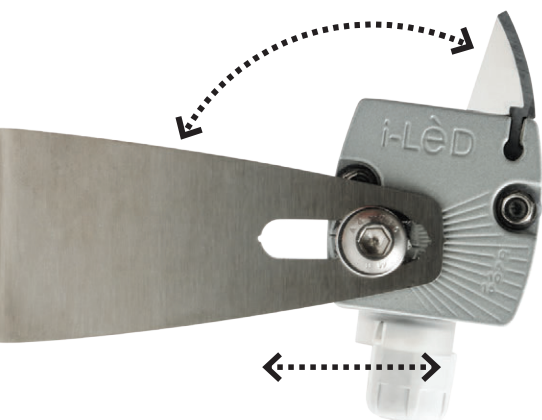

Steel **98949**

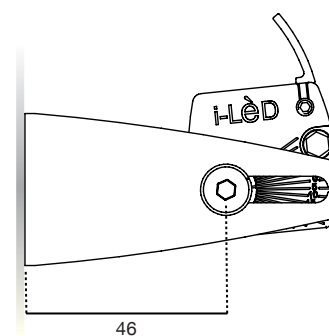
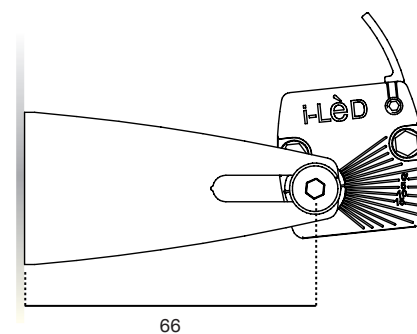

### Fixing steel brackets

#### Fixing brackets

Brackets for fixing and rotating Xenia linear spotlights. Polished AISI 304.

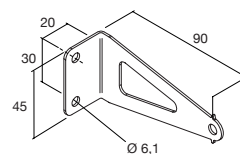

Steel **89045**

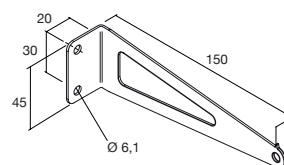

Steel **89046**

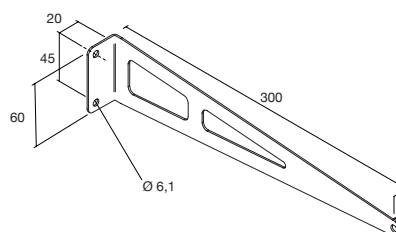
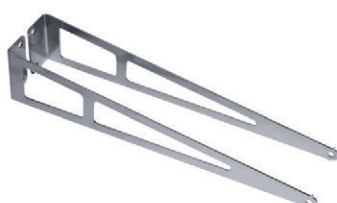

Steel **89047**