



A must for the finest outdoor accent lighting, JADE 16 houses sixteen high power RGBW LEDs, as well as in-built electronics and power supply unit. Providing a vibrant and brilliant colour palette from such a compact chassis, JADE 16 features functional efficiency and is capable of creating visual interest to specific architectural features or details, boosting their peculiarity with differently shaped optics outputs.



TECHNICAL SPECIFICATIONS

16 high brightness RGBW or white power LEDs unit
Continuously variable light intensity
DMX, automatic and Master-Slave mode
Remote firmware update (RFU)
RDM function
Infrared remote control
Power supply:
standard 100÷240V / 50-60Hz
Power consumption:
0.4A @ 230V / 38W max
Electrical class: I
Self-resetting fuse protection
Meets CE and CSA safety standards
Aluminium body

IP66
Operating temperature:
-40°C to 50°C (-40°F to 122°F)
Integrated electronic thermal protection management
Polar Edition, featuring an integrated de-icing system with electrically heated glass, available on request.
2 Kg

DIGITAL CONTROL SYSTEM SPECIFICATIONS AND CONFIGURATIONS AVAILABLE ON OUR WEBSITE



JADE 16

FAÇADE LIGHTING

CODES

AL4050 JADE 16

AL4050	NA	RW	PE
CODE	+ OPTICS	+ LED TYPE	+ OPTION

OPTICS

NA Narrow
ME Medium
WI Wide
EW Extra wide
EL Elliptical
WL Elliptical Wide

LED TYPE

RW RGBW
CW Cold white
WW Warm white
DW Dynamic white

OPTION

PE Polar edition

NOTES

Jade 16 must always be purchased with AL1321 Infrared Remote Control. More Jade 16 units can be controlled with one AL1321. On request, Jade 16 is available also in the CSA certified version.

ACCESSORIES



AL4365 BARNDORF



AL1321 INFRARED REMOTE CONTROL



AL4122 VISOR



AL4123 SNOOT

FEATURES AND OPTIONS

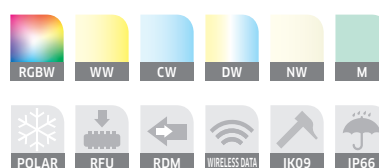

BEAM ANGLE REFERENCE

NARROW	13°
MEDIUM	29°
WIDE	40°
EXTRA WIDE	58°
ELLIPTICAL	12°x34°
ELLIPTICAL WIDE	29°x51°

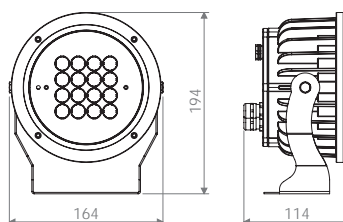

PHOTOMETRIC DETAILS AVAILABLE ON OUR WEBSITE





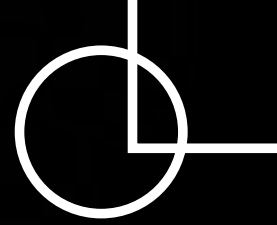

FAÇADE LIGHTING



 GRIVEN